

Investment delivers a new dimension for FC Laser

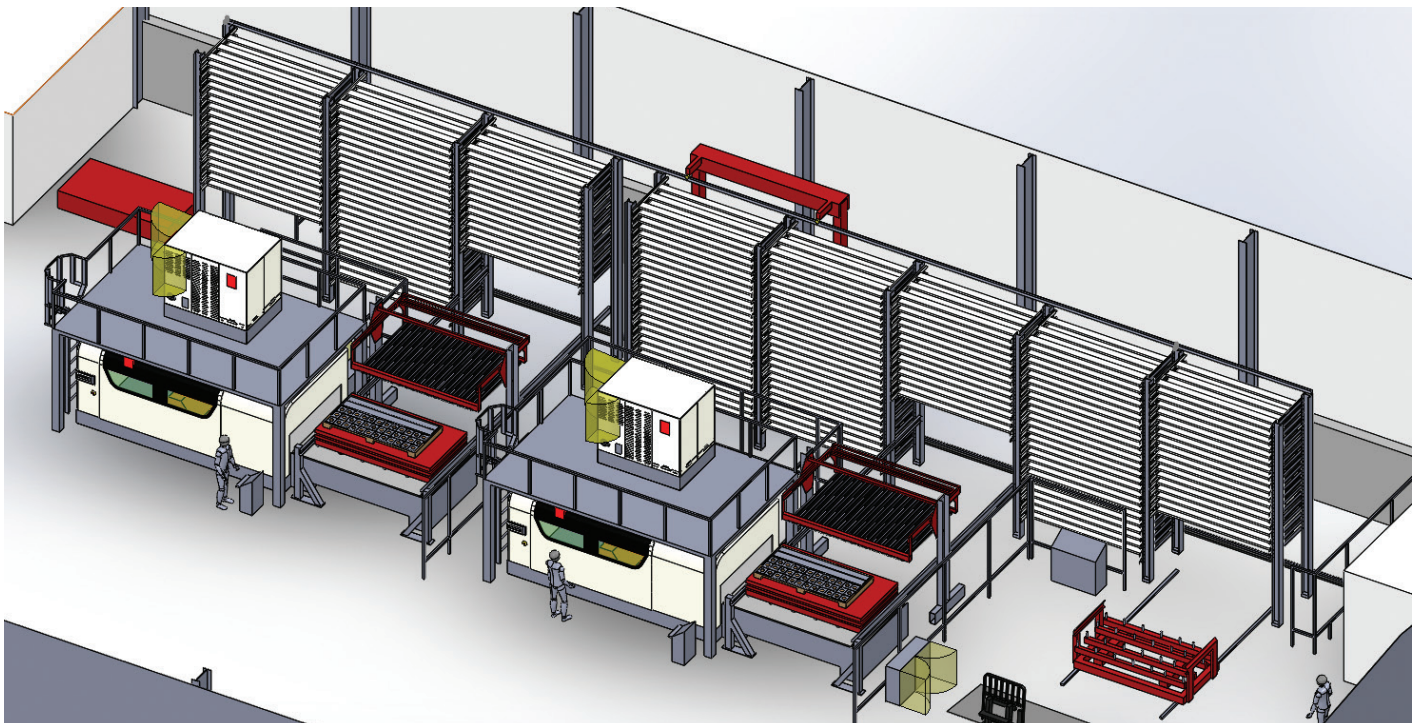

Automated Precision Laser Cutting
Contact FC Laser at: sales@fclaser.co.uk

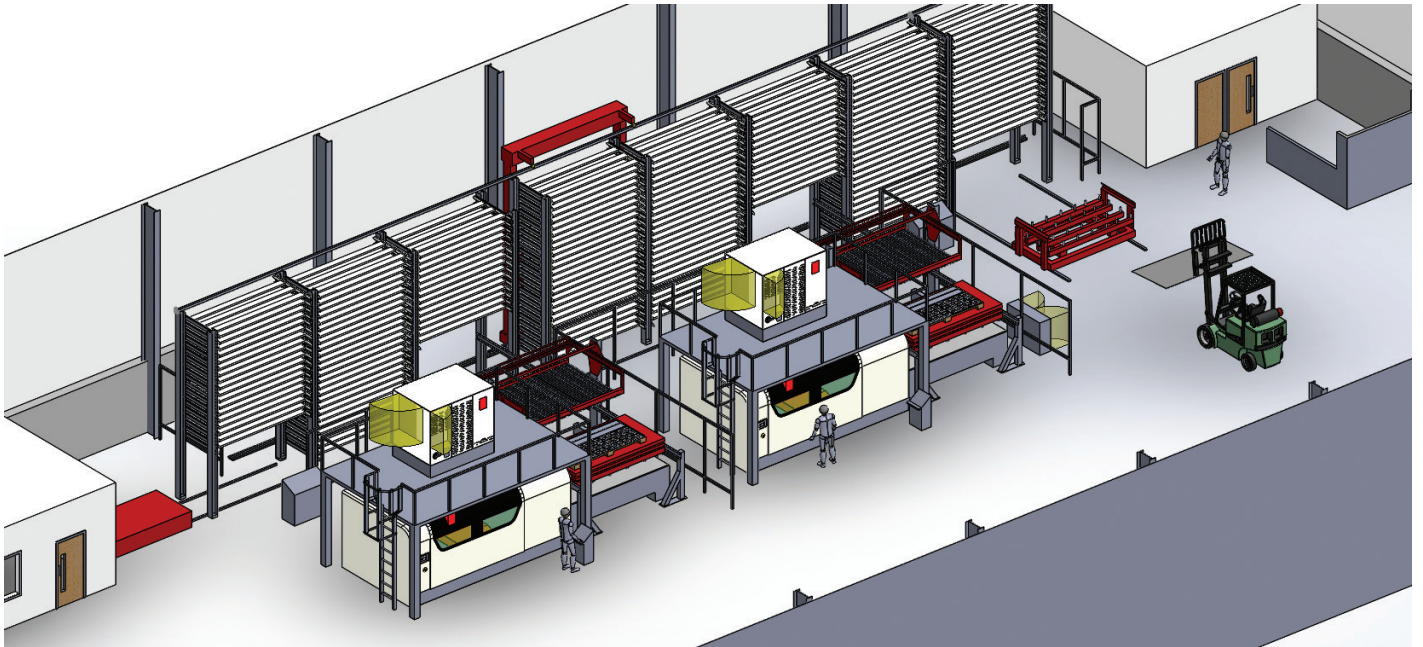

Welcome to FC Laser the fastest growing precision laser cutting company in the UK, we have committed to an ambitious £2.5M Investment plan with the introduction of two 12Kw ByStar Fiber Lasers, a fully Automated Tower Storage System and a fully Automated Paint Line. This is perfectly complemented with further improvements in our continuous improvement techniques and continual scrutiny of our quality standards.

Q&A with FC

Q: *What makes FC Laser the 'Go To' Laser cutting, metal bending and fabrication service provider?*

A: We believe our philosophy towards investment, which includes our staff, equipment, systems and production facility makes us the company we are today.

Our team benefit from our unique training and development programme. The future growth of the business is just as reliant on its investment in its people, as it is in having the very latest high-tech machinery and systems.

Our processes and systems are the first step in delivering a service and quality that exceeds our customers' expectations but our staff go that extra mile and make a real positive difference.

The Team at FC Laser have a great attitude and help wherever possible to ensure deliveries are on time and are always available to offer outstanding technical support. We strongly believe in visual management and have invested in the very latest ERP system that streams live job data to TV screens throughout the factory. Each sales order is broken down to key milestones that need to be hit to ensure we deliver on time. If at any point we start to waver from these milestones we are instantly informed, providing us the time and opportunity to proactively get the sales order back on track and successfully delivered on time to our customers'.

Our culture and customer focus, is supported with state-of-the-art manufacturing with the very latest Bystronic Fiber Lasers and the the LT7 fiber tube laser which is by far the most complete and advanced laser cutting tube available on the market today. Perfectly complimented with our five new press brakes the new 4M 320 tonne Bystronic Xpert 320, an Xpert 150 press at 3M and a suite of Xpert 40's. Appended to the impressive Xpert 40 press brake is a state-of-the-art mobile bending robot that improves efficiencies with consistent and repeatable accuracy of complex folds. All this within our State-Of-The-Art Manufacturing facility keeps us extremely competitive and offering a consistently high quality service.



“Our company goal is to offer a world class service to all of our customers’.”

Danny Fantom
Managing Director

PRECISION 4M FIBRE LASER CUTTING

With the very latest Bystronic CO2 and Fibre Lasers Cutting Machines we are in the enviable position to offer the very highest cutting standards at competitive prices.



FC Laser have introduced the next level of power in Fibre laser cutting: the innovative, high performance ByStar Fiber laser cutter with 12kW Fibre source. With high cutting dynamics, thin to thick cutting capabilities, seamless automation solutions and intelligent sensor technology, which is fully integrated with the very latest software systems.

Exceptional cutting quality in thick plate cutting with BeamShaper

The BeamShaper allows for an ideal adjustment of the laser beam profile for cutting thick steel plate with diverse material characteristics. In steel materials up to 1.125 inch, the new function raises the quality of the cut surface and increases the cutting speed by up to 20 percent when cutting with oxygen.

BeamShaper delivers:

- ✓ **Power and Speed** - Ability to cut 30mm mild steel up to 20% faster
- ✓ **Quality** – great edge quality in 20 – 30mm mild steel – Easy part removal
- ✓ **Flexibility** – High variety of material can be cut easier with a better quality finish
- ✓ **Reliability** – Wider kerf for easy unloading – higher focal tolerance in thick mild steel delivering process safety

More key benefits:

- ✓ Automatic Nozzle changing facility combined with the very latest software systems and the automated warehousing will allow FC Laser to deliver a 25% Increase in production capacity
- ✓ The Cutting head has spot control which ensures it cuts the complete thickness range without compromise, with only one focus lens ensuring no focus shift for process stability
- ✓ Detection Eye delivers extremely fast and accurate edge detection, reducing non- productive time
- ✓ Cut control – No waste with automatic cut off and the shortest piercing time through pierce trough detection



Where possible we try to reduce our customers' manufacturing and shop floor handling time.

Our value added laser services include:

- ✓ Laser part etching and weld positions for assemblies – if you are using chalk to mark laser parts, you can now do this operation on the laser, it is cheaper and more precise.
- ✓ Laser cut apertures 60% of the plate thickness as standard (less on request). This opens design opportunities and eliminates expensive secondary machine operations.

PRECISION FIBRE TUBE LASER CUTTING



The LT7 fiber tube laser is by far the most complete and advanced laser cutting tube on the market today. Our facility perfectly balances efficiency in production and quality. The LT7 allows automatic tube changes whilst achieving maximum accuracy adapting the cutting head to the real working conditions of the tube quality.

Entire traditional machining operations can now be laser cut, removing from the manufacturing process sawing, deburring, punching, notching, drilling and milling. Eliminating these multiple, traditional machining operations prevents potential accumulative errors associated with consecutive manufacturing processes and all of the associated handling and touch-time costs.

“As demanded by our customers’ we aim to deliver a ‘one stop shop’ with the highest levels of attention to detail and service.” Danny Fantom (Managing Director)

One of the key benefits of laser cutting tube is the savings users receive in direct labour and reductions in cycle times, 70 percent process time savings are not uncommon.

Also, the freedom from the restrictions of traditional machining processes, allows new levels of creativity and innovation which can revolutionise all aspects of production, from design, manufacture through to final assembly.

“As demanded by our customers’ we aim to deliver a ‘one stop shop’ with the highest levels of attention to detail and service.”

Danny Fantom (Managing Director)



By providing a high-technology but cost effective solution, the LT7 fiber lasertube simplifies production planning and job routing. Due to its inherent accuracy, it produces genuine production benefits in simplifying or eliminating welding jigs or even the welding process all together. The LT7 fiber lasertube requires no hard tooling and, if STEP files are provided, programming to cutting takes only a few minutes. This creates instant benefits when producing prototypes or making design enhancements, as costs and delivery timescales are reduced.

Quality is the most important factor at FC Laser. Our focus is to ensure we deliver a solution that meets the needs of our customers'. This covers quick and on time deliveries, technical support to help reduce or even eliminate additional machining and welding processes from your manufacturing cycle and dedicated account management to ensure your requirements are always met.

LT7 key features and benefits:

- ✓ **Fibre technology** offers the most productive and cost effective laser cutting solution compared to CO2
- ✓ **Active Scan** compensates for potential errors induced by distorted tubes
- ✓ **Active Speed** adjusts parameters in real time according to the conditions of the tube creating superior cut quality
- ✓ **Active Marking** allows etching of part numbers, ID, order numbers or anything else for traceability
- ✓ **Active Weld** detection requires no mechanical adjustment. The LT7 detects weld positions using optical sensors and sets up accordingly.

CNC FOLDING & MACHINING

Customers expect extra value to their laser components. Continuing our partnership with Bystronic we have five new press brakes with state-of-the-art mobile robotic bending that improves efficiencies with consistent and repeatable accuracy of complex folds. Our machine shop can countersink, drill and tap whilst also offering a pemming service.

Working with Bystronic we have five new press Brakes offering sophisticated metal bending services in-house.

The star of the show is the latest press, the new 4M 320 tonne Bystronic Xpert 320. It is complemented by the Xpert 150 press at 3M and a suite of Xpert 40's. Appended to the impressive Xpert 40 press brake is a state-of-the-art mobile bending robot, improving efficiencies with consistent and repeatable accuracy of complex folds.

This highly efficient bending capacity, combined with the latest ERP systems puts FC Laser in a strong position to provide an unrivalled level of service, expertise and solutions to it's expanding customer base.



For more information contact: sales@fclaser.co.uk

CONTINUOUS IMPROVEMENT

We employ continuous improvement techniques that more established competitors find hard to match. The recent introduction of large TV screens linked to the ERP system has meant that management has an up to the minute overview of what stage of production each job is at. Combined with individual digital feedback 'kiosks' on the shop floor, team members can give immediate feedback and suggest improvements to work processes. We believe that this level of digital feedback is unique within the industry. Customer service is at the very heart of everything that we do, utilising 5S continuous improvement processes.

“FC Laser is all about making the process of laser cutting, folding and fabrication as efficient and as environmentally friendly as we can.”

Danny Fantom Managing Director

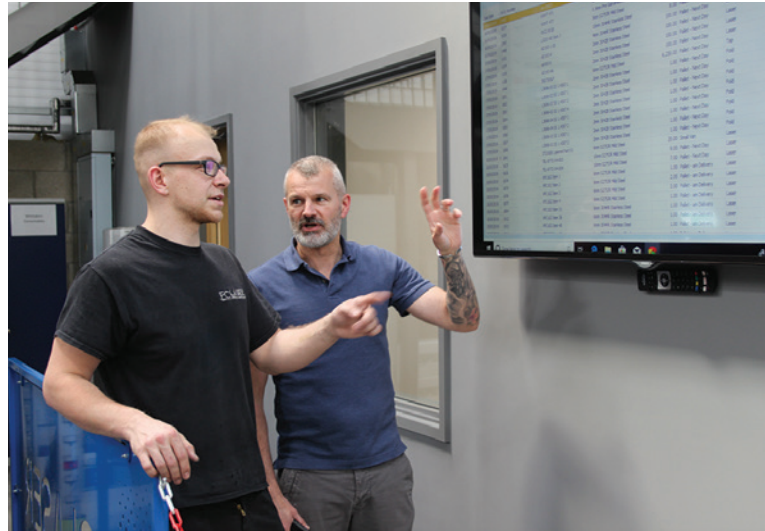

Quality

Our commitment to quality is more than just the Standards we hold, which include ISO 9001 and EN1090. Our philosophy is to provide the quality service we expect from our supply chain. This is ingrained in our company culture and right from the beginning our skilled Sales Team will work with customers and Technical Teams to provide the best advice to produce to the quality and tolerance standards required at the most cost effective price. With dedicated Quality Inspectors we continually check the accuracy of parts being laser cut and formed, not just for tolerances but also for aesthetics of cut and material quality. We regularly review our processes and paperwork to ensure they are robust enough to ensure the accurate manufacture, packaging and part identification of jobs.

“We pride ourselves on limiting our impact on the environment too. Through our investment in Fibre Laser Technology we have reduced our electrical and gas usage whilst offering better prices and more diverse ranges of materials processed to our customers.”

Danny Fantom Managing Director



State-of-the-art automated warehousing system

The interlocking systems will allow FC Laser to multiply the efficiency of the production facility, reduce the processing times of the individual projects and optimize the use of the extensive production capability.

key features:

- ✓ Extraordinary compactness
- ✓ Fully customized layout and dimensioning
- ✓ Flexible enlargement due to the expandable modularity
- ✓ Interfacing with computer system, to allow the real time management of stocks and the flexible management of the production plans

Dan Thombs commented

“ At Bystronic we aim to be industry leaders in technology, providing equipment and software that help our customers stand out in a competitive market.

Our strategy is to build close relationships with our customers, to understand their business and to provide the best possible solutions to meet their needs. It is always great to work with FC Laser, Danny Fantom and his team, who have a similar outlook, are focused on ensuring they operate the latest equipment, technology and software to deliver on the commitment to their customers.

After fully integrating their production management systems with Bystronic Plant Manager software last year, FC Laser will further enhance their production capability in 2020 with the introduction of their first ByStar 12kW machine in June and have now become the first UK manufacturer to order a second 12kW machine. To maximise the effectiveness of these class leading machines, FC Laser will introduce a fully automated Tower Storage System in December. The Tower Storage System will enable FC Laser to realise the maximum benefit from the performance of the two 12kW Lasers and bring major improvements to the process flow, logistics and efficiency of labour. When combined with the investments made in operational software it will place FC Laser in a strong technical position for the future. ”

Dan Thombs Managing Director Bystronic UK Limited

FC team contacts



Danny Fantom

Managing Director

danny@fclaser.co.uk



Lisa Fantom

Company Director

lisa@fclaser.co.uk



Daryl Lowe

Operations Manager

daryl@fclaser.co.uk



Emma Thomas

Accounts Manager

emmat@fclaser.co.uk



Greg Kirkby

Sales Account Manager

greg@fclaser.co.uk

07718326329



Brett Armitage

Sales Account Manager

brett@fclaser.co.uk

07590882870



Nick Watson

Sales Account Manager

nick@fclaser.co.uk

07720825517



Please visit our website www.fclaser.co.uk for lots more information and view the LT7 in action and see what it could do for you.